

Hydrim C61 G4 Dosing System

Filling the Dosing Reservoir

When the Hydrim C61 G4 is installed and the chemical (detergent) is connected you should touch the Salt/Detergent Icon, next touch the hand pointing to the "X" next to detergent. The Chemical Pump should turn on and fill the Dosing Reservoir with soap. The "X" next to detergent should change to a green check mark "✓" which indicates the dosing reservoir is filled with detergent.

Note: When connecting chemical (detergent) at initial installation you may need to touch the hand icon more than once.



Salt/Detergent Icon

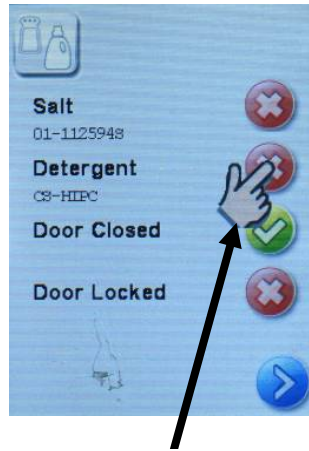

Hand



Green check mark indicates detergent reservoir is full

If you start a cycle without connecting the chemical (detergent) bag or touching the hand to fill the Dosing Reservoir, the display will show Replace Detergent. Install a chemical (detergent) bag or touch Replace Detergent and the green check mark should appear next to detergent when the Dosing Reservoir is full. Touch the back arrow and select the desired cycle.

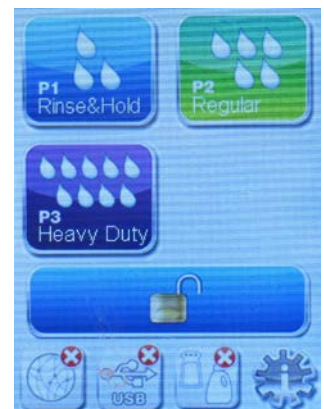
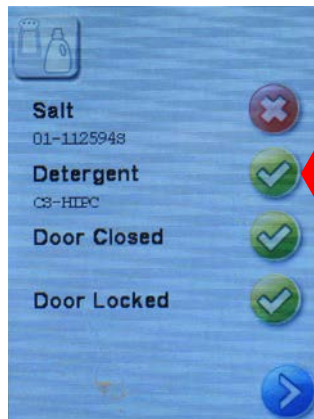
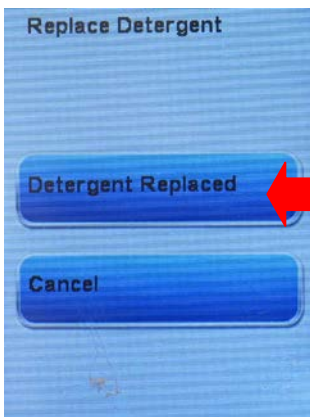

Hydrim C61 G4

Troubleshooting CF21

Dosing System Error

Dosing system failed to dispense the preset amount in a predefined time (timeout is 3.5s/pulse). Dosing reservoir level switch does not change from full ON to OFF by the end of dosing (no chemical dispensed)

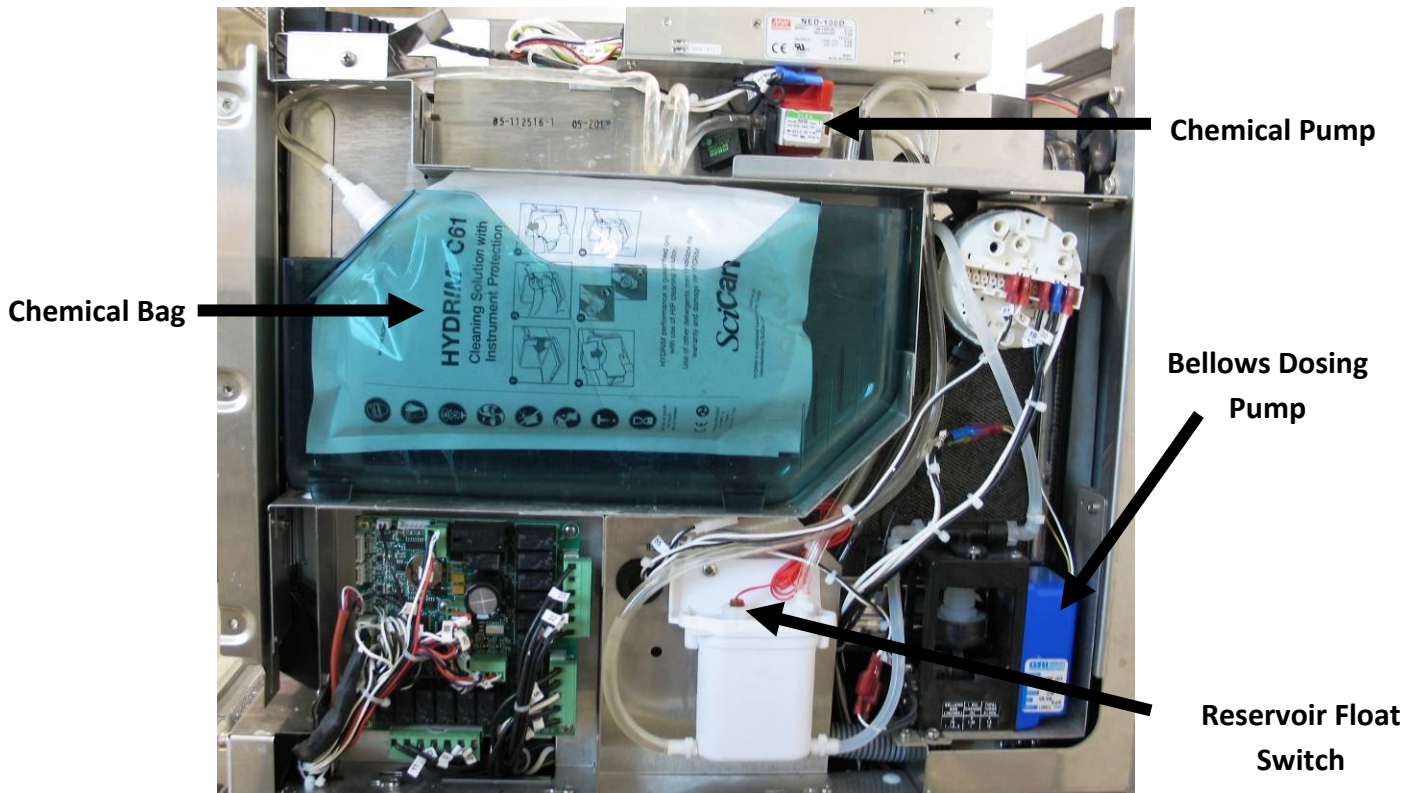

When troubleshooting a CF21 (Dosing System Error) first check that the chemical (detergent) bag is not empty. Check the hose connection to the chemical bag.

Go to the technician menu, diagnostic tools, component test & dosing system

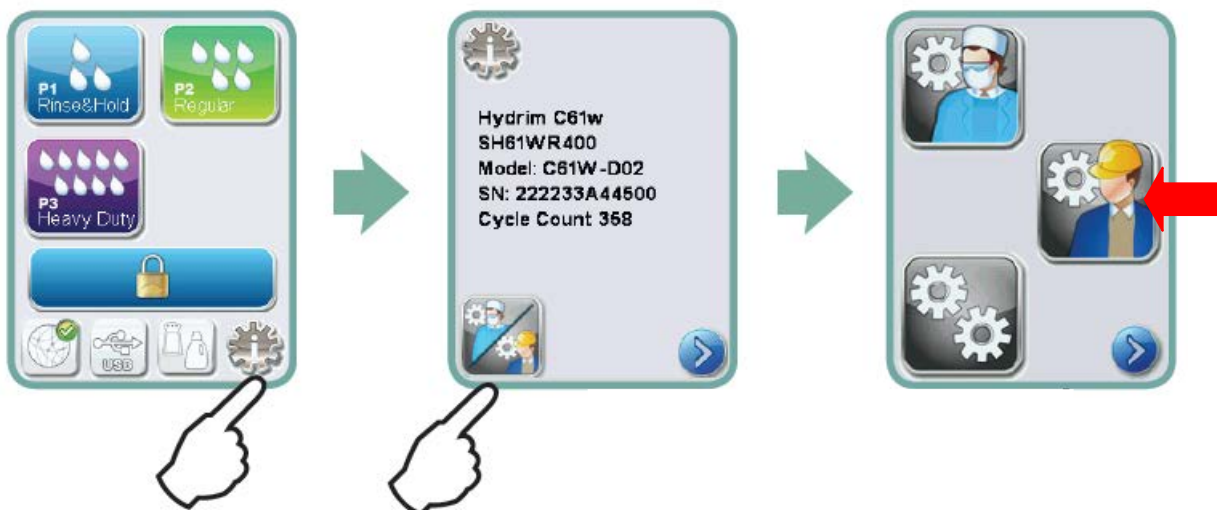

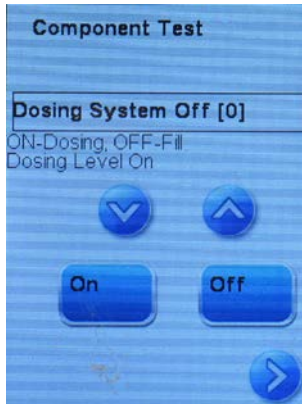
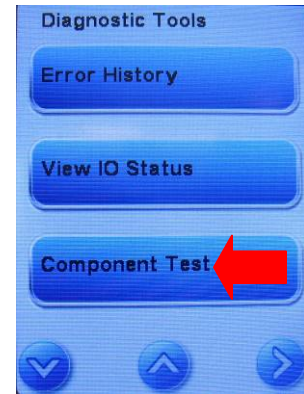
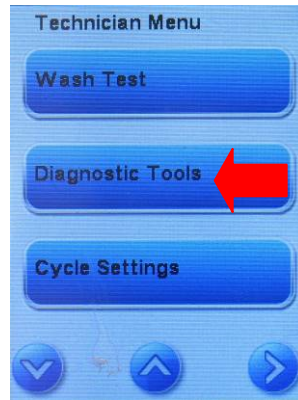

The On button turns on the Bellows Dosing Pump. The Bellows Dosing Pump, pumps chemical (detergent) from the Dosing Reservoir into the chamber. Dosing Level should turn off as detergent is pumped into the chamber. A micro-switch will count the strokes of the pump.

The Off button turns on the Chemical (Detergent) Pump. The Chemical Pump fills the Dosing Reservoir from the Chemical Bag.

The Dosing Level indicates the position of the float switch in the Dosing Reservoir. If the Dosing Level is on the switch is indicating the reservoir is full of chemical and the Chemical Pump will not run.