

4. Installation Instructions

To open the wash chamber door, plug in the unit, turn it on and press the unlock symbol.

Alternatively, remove the screw in the kickplate and pull the ring.

Tools and supplies required for installation:

- Slot screwdriver
- Channel locks

Specifications:

| | |
|---------------------------------|-------------------------------------|
| Voltage: 208 – 240 V | Height: 850 mm / 33.5" |
| Frequency: 60 Hz | Width: 600 mm / 23.75" |
| Rated load: 2 kW | Depth: 600 mm / 23.75" |
| Circuit breaker: 15 A per phase | Depth with door open: 1200 mm / 47" |
| | Weight: 80 kg / 176 lbs |
| | Running Noise: 60 dBA |

Utility Hook-ups

| Hose / Cord | Length / Diameter | Max. Distance from inlet / drain | Water Pressure | Shut-off valve |
|-------------|--------------------|----------------------------------|-------------------------|----------------|
| Hot inlet | 1.9 m / 6 ft. 3/4" | 1.5 m / 5 ft. | 1-10 bar / 14.5-145 psi | Yes |
| Cold Inlet | 1.9 m / 6 ft. 3/4" | 1.5 m / 5 ft. | 1-10 bar / 14.5-145 psi | Yes |
| Drain | 1.5 m / 5 ft. 3/4" | — | — | — |
| Electrical | 1.8 m AWG 14-3 | — | — | — |

Installation:

If the Hydrim is installed in a Sterilization Center, the manufacturer of the Sterilization Center should allow a 10mm / 1/2" space at the top, back and both sides of the Hydrim. This will facilitate installation, and service access to the Hydrim.

Do not move the Hydrim into place by maneuvering the open wash chamber door. This may cause to door to become misaligned and leak.



For safety reasons, do not install the Hydrim without the top cover.

Leveling the Hydrim:

The unit is standing on three supports: rollers (wheels) at the back and two legs at the front.

1. Remove the kickplate. Push the Hydrim into place while lifting the strap at the front to allow the unit to roll on the rollers.
2. Adjust the front legs as required until the Hydrim is level. Access the legs from inside the unit.
3. The rear two legs are used only if the floor is uneven or cannot provide support to the rollers.



power cord

cold water inlet hose

hot water inlet hose

drain hose

rollers

4. Installation Instructions

Connecting the water inlet hoses:

Connect the hot and cold water inlet hoses to the hot and cold water supply.

Drain requirements:

Connect the drain hose to the drain outlet. The drain hose can be attached to existing drain lines using a 3.5 cm / 1.5" or larger standpipe / P-trap combination. If the hose is connected directly to the drain line, fittings and adapters should not reduce water flow. The drain hose should be attached to the main drain at a point no more than 1 metre / 3 ft. above the base of the Hydrim. A floor drain is acceptable (check local codes).

Electrical requirements:

Connect the electrical cord to the power supply. The Hydrim must have a dedicated circuit equipped with a 15A fuse. The outlet must be grounded.

Additional Information:

- The Hydrim unit is heavy. Use a forklift or dolly and exercise caution when moving it.
- The Hydrim should be serviced on site.
- The Hydrim is equipped with an air gap / anti-suction device to prevent backflow of dirty water into the water supply. No other air gap device is necessary.
- If you need to extend the water inlet and drain hoses, ensure that you use commercial grade plumbing hose. The maximum length of the drain hose is 3.3 m / 13 ft.

Installing Cleaning Solution:

Install HIP Cleaning Solution as follows:

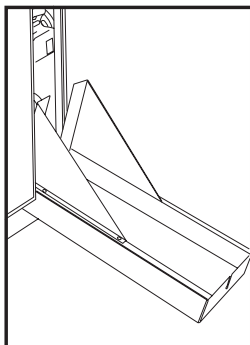

Open the cleaning solution drawer.

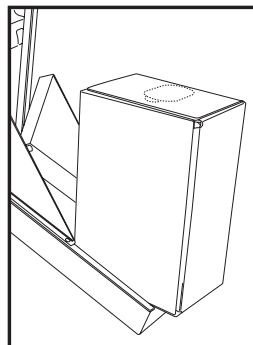

Put a new cleaning solution box into the drawer upside down.

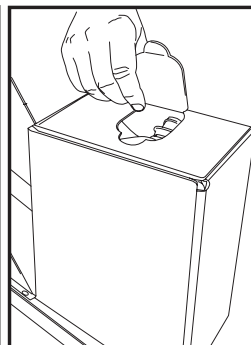

Tear open the tab.

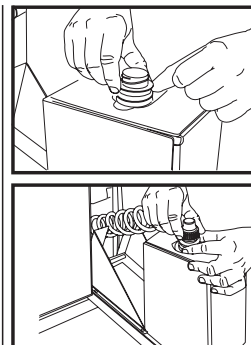

Pull out the spout and remove the protective cap. Connect the hose.

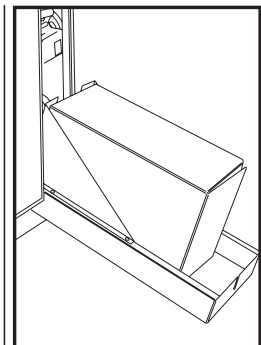

Place the box in the cleaning solution drawer and then close.

Testing water hardness and setting the water softener (salt):

Hydrim is equipped with a built-in water softening system which needs to be adjusted according to the local water hardness. The Hydrim water test kit includes three water hardness test strips in bags. Take a water sample from the location where the machine will be installed. Open one of the bags and remove the test strip. Dip the strip in the water. Compare the color of the strip with the chart on the back of the bag. Determine the water hardness according to the chart on the water test kit envelope. Power the unit on. Touch the "i" in the lower right hand corner of the screen. Select

"Setup" and then "Set Regeneration". Using the up and down arrows, set the water softener regeneration level according to this table:

| Hardness – ppm | Hydrim setting |
|----------------|--------------------------|
| 0 - 180 | 0 |
| 190 - 210 | 1 |
| 220 - 250 | 2 |
| 260 - 300 | 3 |
| 310 - 350 | 4 |
| 360 - 400 | 5 |
| 410 - 540 | 6 |
| 550 - 890* | 7 |
| > 890 | water treatment required |

* consider using an additional water treatment

Unscrew the salt container lid and pour 1 litre / 1 quart of water into the water softener. Add 1 kg / 2.2 lbs of water softening salt in the same manner. Screw the salt container cap on tightly.



Installation Test: Turn on the shut-off valves. Run a cycle, checking for leaks in the plumbing connections.

Optional Installation Configurations

Option 1. Free Standing

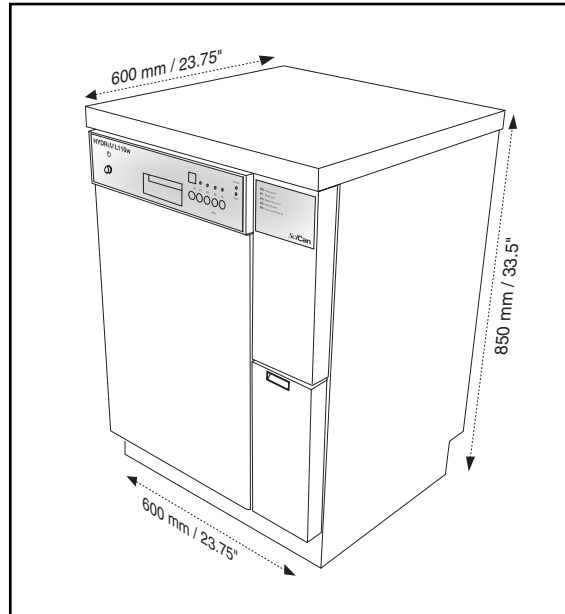

Option 2. Under Counter

